



Property details	
Beds	2
Baths	1
Parking spaces	1
Reception rooms	2
Gardens	1
Status	Leasehold
Tenure	For Sale
Energy efficiency rating	B
Energy efficiency	Current: 81.0, potential: 87.0
Environmental impact	Current: 74.0, potential: 83.0
Investment returns	
Current monthly rent	£650 pcm
Current rental yield	8.2%
Potential market value rent	£767 pcm
Potential rental yield	9.7%
Estimated monthly capital appreciation	-£463
Area capital appreciation rate	-3.7%
Market dynamics	
Market velocity	Slow moving
Average days on market	138
Monthly stock turnover	22%
5-year net area growth	+17.9%

Features

Downstairs Family Bathroom

EPC B-Potencial C

On-street parking

BUY TO LET INVESTORS ONLY - SOLD WITH TENENTS IN SITU

Current Rent £500 pcm=7.5% Gross Yield pa

Council Tax Band A

In need of Modernisation

Utility Room

2 Reception Rooms

Leasehold-906 Years Remaining

BUY TO LET INVESTORS ONLY-SOLD WITH TENANT IN SITU CURRENT RENT £500 PCM-POTENTIAL £650 PCM
LEASEHOLD-906 YEARS REMAINING EPC B Energy performance certificate (EPC) – Find an energy certificate –
GOV.UK IN NEED OF MODERNISATION/REFURBISHMENT This two-bedroom mid-terraced house presents an
excellent opportunity for buy-to-let investors, offered for sale with tenants in situ. The property is current...

View full description at <https://www.moveplaces.co.uk/properties-for-sale/097f191d-c28a-45f5-a607-bda37afaa065>

Floor plans

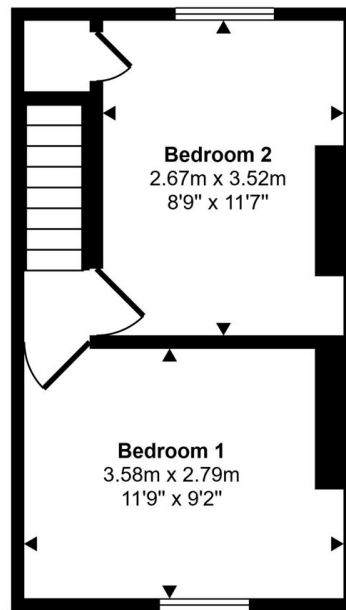

First Floor

Approx 23 sq m / 247 sq ft

Whilst every attempt has been made to ensure the accuracy of the floor plan contained here, measurements of doors, windows, rooms and any other items are approximate and no responsibility is taken for any error, omission, or mis-statement. The measurements should not be relied upon for valuation, transaction and/or funding purposes. This plan is for illustrative purposes only and should be used as such by any prospective purchaser or tenant.

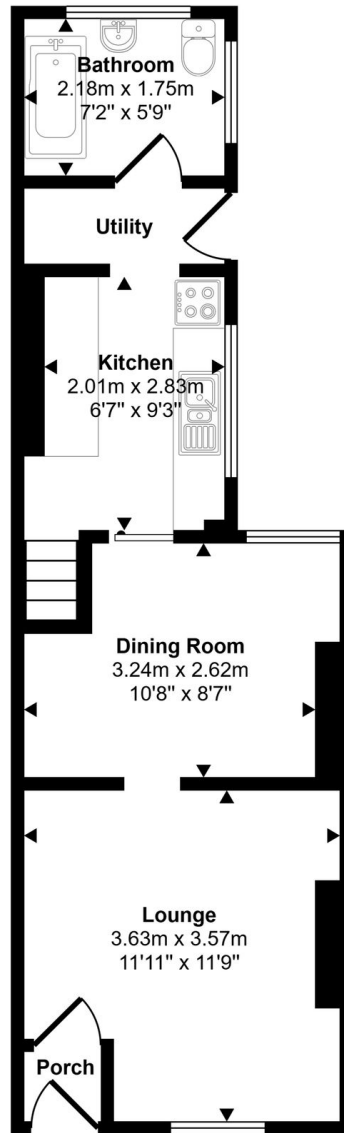

Ground Floor
Approx 35 sq m / 381 sq ft

Whilst every attempt has been made to ensure the accuracy of the floor plan contained here, measurements of doors, windows, rooms and any other items are approximate and no responsibility is taken for any error, omission, or mis-statement. The measurements should not be relied upon for valuation, transaction and/or funding purposes. This plan is for illustrative purposes only and should be used as such by any prospective purchaser or tenant.

Approx Gross Internal Area
58 sq m / 629 sq ft

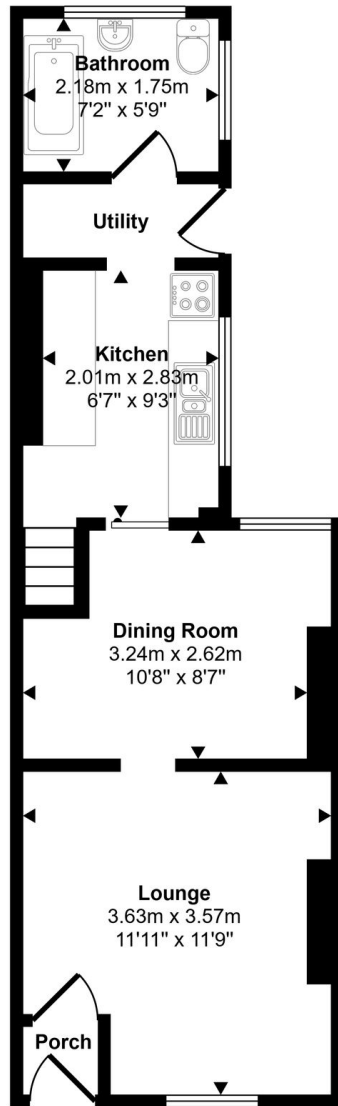

Ground Floor
Approx 35 sq m / 381 sq ft

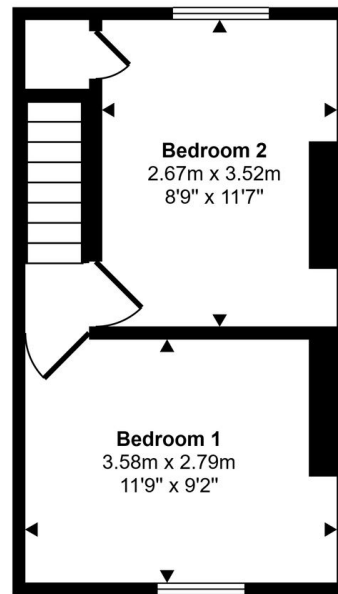

First Floor
Approx 23 sq m / 247 sq ft

Whilst every attempt has been made to ensure the accuracy of the floor plan contained here, measurements of doors, windows, rooms and any other items are approximate and no responsibility is taken for any error, omission, or mis-statement. The measurements should not be relied upon for valuation, transaction and/or funding purposes. This plan is for illustrative purposes only and should be used as such by any prospective purchaser or tenant.



View full details at <https://www.moveplaces.co.uk/properties-for-sale/097f191d-c28a-45f5-a607-bda37afaa065>