



Property details	
Beds	3
Baths	1
Parking spaces	1
Reception rooms	1
Gardens	1
Status	Freehold
Tenure	Under Offer
Energy efficiency rating	D
Energy efficiency	Current: 62.0, potential: 85.0
Environmental impact	Current: 60.0, potential: 85.0
Investment returns	
Current monthly rent	£1075 pcm
Current rental yield	6.3%
Potential market value rent	£1335 pcm
Potential rental yield	7.8%
Estimated monthly capital appreciation	-£635
Area capital appreciation rate	-3.6%
Market dynamics	
Market velocity	Slow moving
Average days on market	117
Monthly stock turnover	26%
5-year net area growth	+22.3%

Features

Council Tax Band A

Spacious Upstairs Family Bathroom

PRICED TO SELL! VACANT & CHAIN FREE

EPC D-Potential B

Lovely Back Garden & Patio Area

Garage to Rear of House

Modern Fitted Kitchen

Ideal First Time Home or Buy to Let

Potential Rent £1300 pcm = 7.4% Gross Yield pa

Open Plan Living & Dining Room

PRICED TO SELL-VACANT & CHAIN FREE EPC D-POTENTIAL B <https://find-energy-certificate.service.gov.uk/energy-certificate/9039-7929-5000-0753-2202> This well-presented three bedroom mid-terraced house is an excellent opportunity for first time buyers and investors alike. The property is offered to the market vacant and chain free, and is attractively priced to sell, making it a straightforward purchase...

View full description at <https://www.moveplaces.co.uk/properties-for-sale/8d2bb668-0a4d-427d-9a04-6e5f8c8ad397>

Floor plans

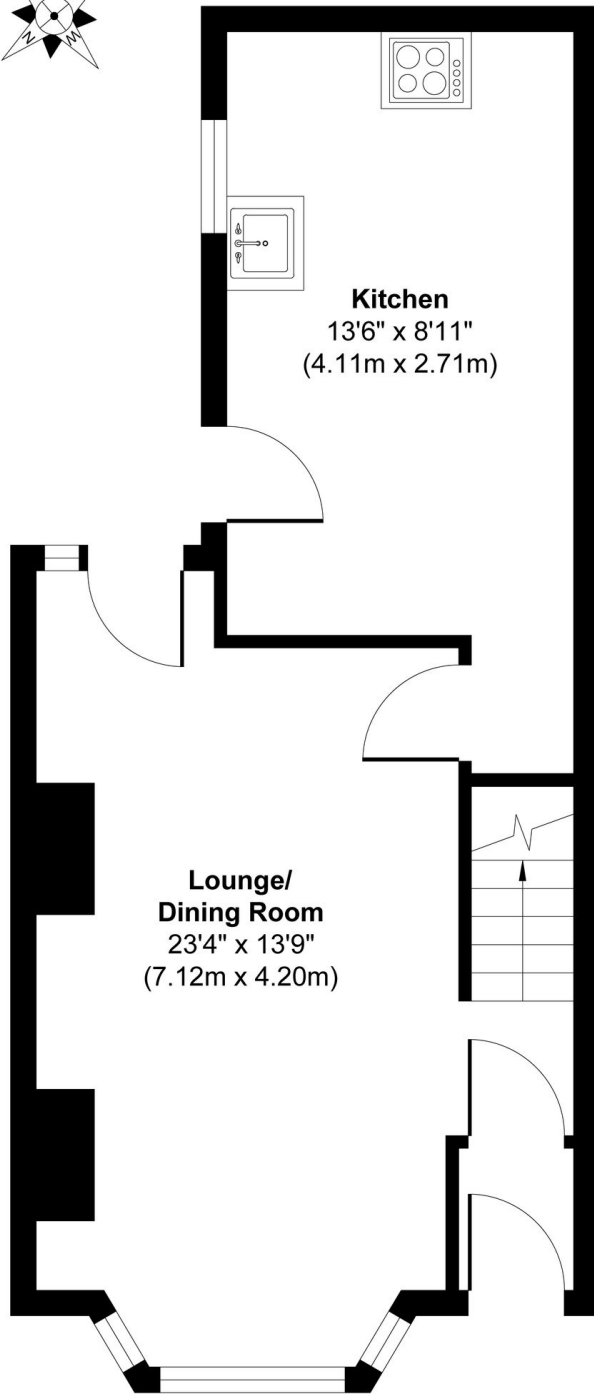

Ground Floor
Approximate Floor Area
389 sq. ft
(36.19 sq. m)

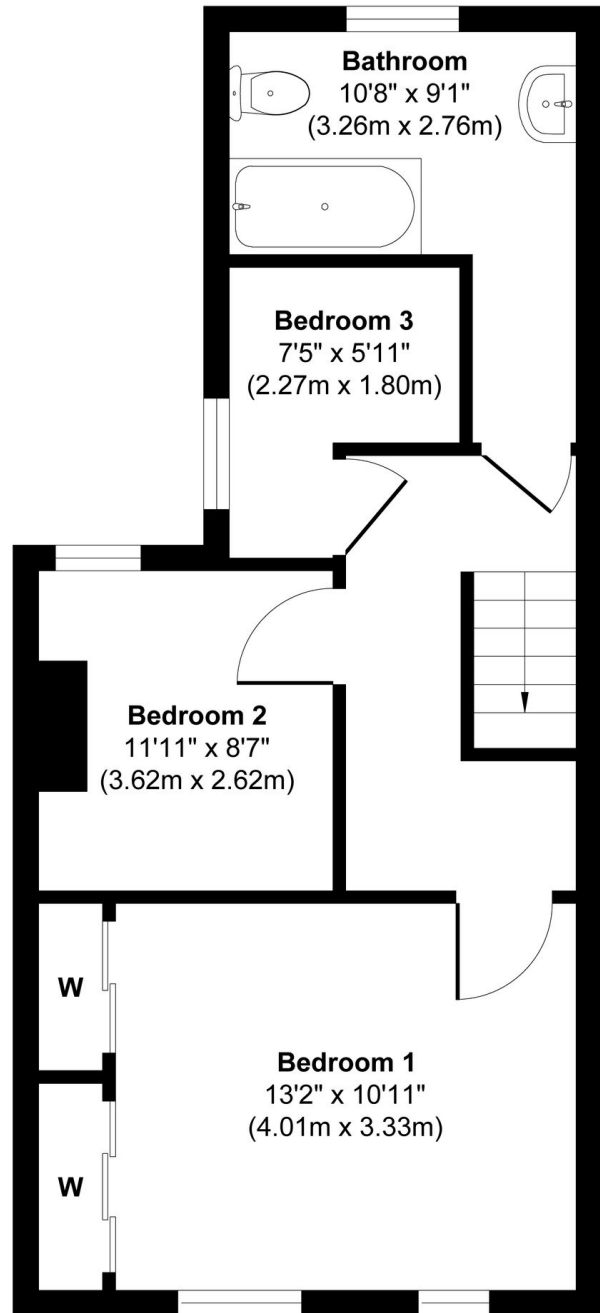

First Floor
Approximate Floor Area
376 sq. ft
(35.01 sq. m)

Approx. Gross Internal Floor Area 765 sq. ft / 71.20 sq. m

Whilst every attempt has been made to ensure the accuracy of the floor plan contained here, measurements of doors, windows, rooms and any other items are approximate and no responsibility is taken for any error, omission, or mis-statement. The measurements should not be relied upon for valuation, transaction and/or funding purposes. This plan is for illustrative purposes only and should be used as such by any prospective purchaser or tenant.



View full details at <https://www.moveplaces.co.uk/properties-for-sale/8d2bb668-0a4d-427d-9a04-6e5f8c8ad397>