



Property details	
Beds	2
Baths	1
Reception rooms	1
Gardens	1
Status	Leasehold
Tenure	Withdrawn
Energy efficiency rating	
Energy efficiency	Current: , potential:
Environmental impact	Current: , potential:
Investment returns	
Current monthly rent	£720 pcm
Current rental yield	3.8%
Potential market value rent	£1159 pcm
Potential rental yield	6.1%
Estimated monthly capital appreciation	-£561
Area capital appreciation rate	-0.8%
Market dynamics	
Market velocity	Average turnover
Average days on market	45 days
Monthly stock turnover	35%
5-year net area growth	+0%

Features

PRICED TO SELL - WITH VACANT POSSESSION

TENURE - Leasehold

LEASE LENGTH - 55 years remaining

GROUND RENT - £120pa

SERVICE CHARGE - You are obligated to contribute a proportionate 1/6 towards the total service charge expenditures for maintenance of the building and common parts.

COUNCIL TAX BAND - C

EPC RATING - TBC

Close to Heathrow Airport

PRICED TO SELL - WITH VACANT POSSESSION TENURE - Leasehold LEASE LENGTH - 55 years remaining CASH BUYERS ONLY SORRY GROUND RENT - £120pa SERVICE CHARGE - You are obligated to contribute a proportionate 1/6 towards the total service charge expenditures for maintenance of the building and common parts. COUNCIL TAX BAND - C EPC RATING - TBC We're pleased to be marketing this attractive, two-bedroom,...

View full description at <https://www.moveplaces.co.uk/properties-for-sale/c9a2e4e5-ce13-4b47-a19b-3ffd05411901>

Floor plans

Approx Gross Internal Area
60 sq m / 645 sq ft

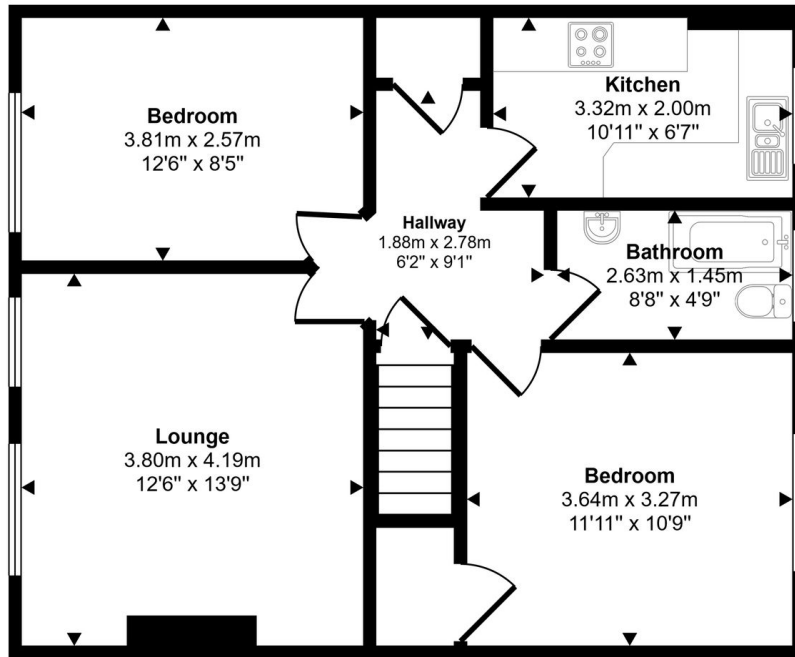

First Floor

Whilst every attempt has been made to ensure the accuracy of the floor plan contained here, measurements of doors, windows, rooms and any other items are approximate and no responsibility is taken for any error, omission, or mis-statement. The measurements should not be relied upon for valuation, transaction and/or funding purposes. This plan is for illustrative purposes only and should be used as such by any prospective purchaser or tenant.



View full details at <https://www.moveplaces.co.uk/properties-for-sale/c9a2e4e5-ce13-4b47-a19b-3ffd05411901>